

# YAMAHA KT100J ENGINE

The KT100J is an ultra reliable engine with low running costs, making it extremely popular as an 'entry level' engine for those entering the sport, or indeed for anyone racing on a tight budget. Used in Midgets, Rookies, Juniors and National Class racing in Australia.

## Yamaha KT100J Engine

Bore: 50.0mm Stroke: 50.0mm

Horsepower: 9

Weight: 10kg (inc. exhaust header)



**K** prefix and red part number indicates Kartech and/or KSI product/s or options available, offering performance, price, quality, size and/or thickness advantage.

Refer to pages 48-50 for further details.

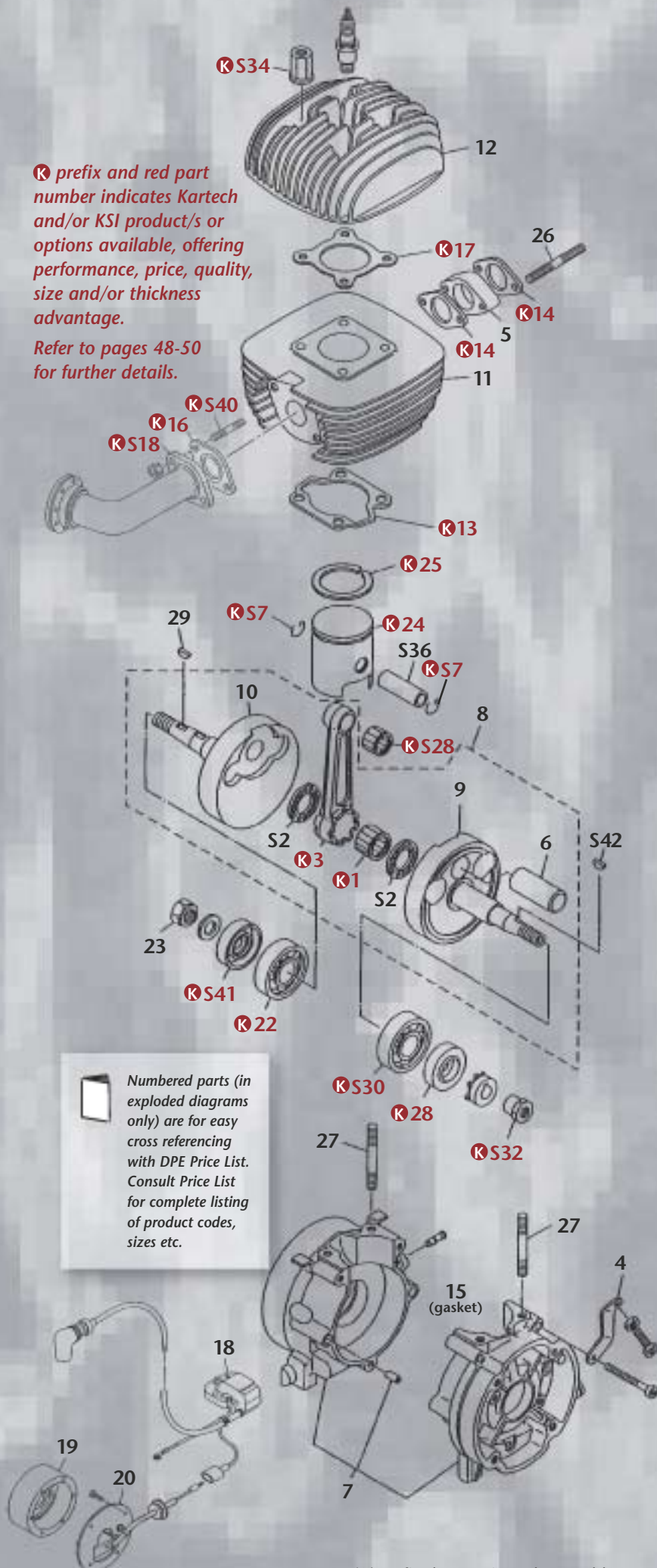

Numbered parts (in exploded diagrams only) are for easy cross referencing with DPE Price List. Consult Price List for complete listing of product codes, sizes etc.

'S' prefix denotes interchangeable part. Refer to KT100SD section for product code.



# YAMAHA KT100SD ENGINE

Various forms of the KT100S engine are used in many countries, making it one of the most popular kart racing engines in the world! Its popularity is due to its perfect mix of low cost, reliability, performance and long life. DPE's experience with this engine is vast, having been involved since its introduction into Australian karting more than 20 years ago.

**Yamaha KT100SD Engine**  
 Bore: 52.0mm    Stroke: 46.0mm  
 Horsepower: 15  
 Weight: 11kg (inc. exhaust header)

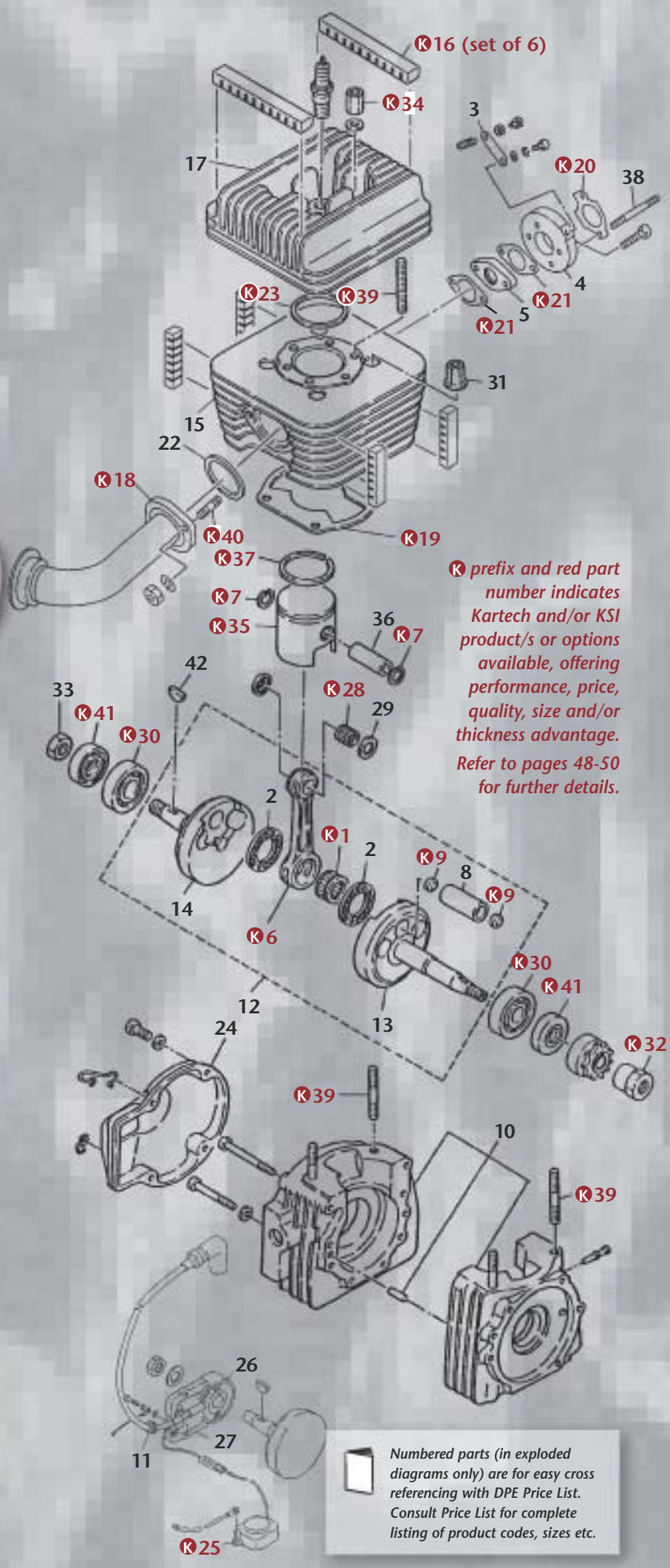

**K** prefix and red part number indicates Kartech and/or KSI product/s or options available, offering performance, price, quality, size and/or thickness advantage. Refer to pages 48-50 for further details.

Numbered parts (in exploded diagrams only) are for easy cross referencing with DPE Price List. Consult Price List for complete listing of product codes, sizes etc.